

8.0. Profile (Landscape) cont..

E USER FRIENDS/FOLLOWERS

Includes:

- list of members user is following
- list of members following the user
- list of other Facebook friends on TRE

GESTURE/s:

- tap headings to expand/contract
- tap member pic/name to visit member profile
- tap follow/unfollow button to add or remove a member from your 'following' list

TRANSITION: TBC

8.1. Edit List Name (Landscape)

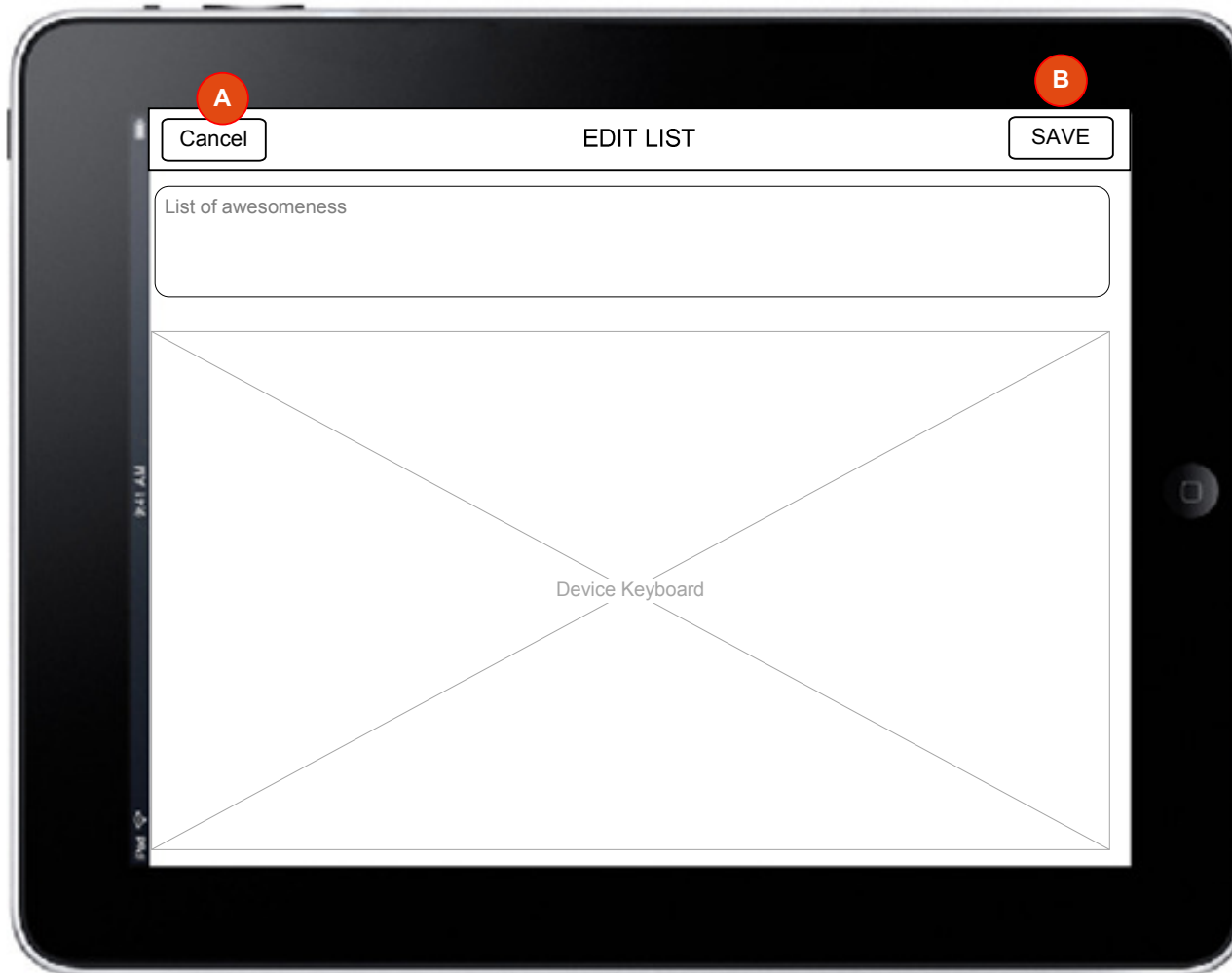

Description

This screen allows users to edit their list name.

The user **arrives at this screen** if:
- user selects edit from their profile screen

A CANCEL BUTTON

GESTURE: tap button to cancel edit

TRANSITION: on tap, user is taken back to their profile screen

B SAVE BUTTON

GESTURE: tap button to save changes

TRANSITION: on tap, the name of the user's list is updated and user is taken back to their profile screen

9.1. Product Detail: Movie (Landscape)

OVERVIEW

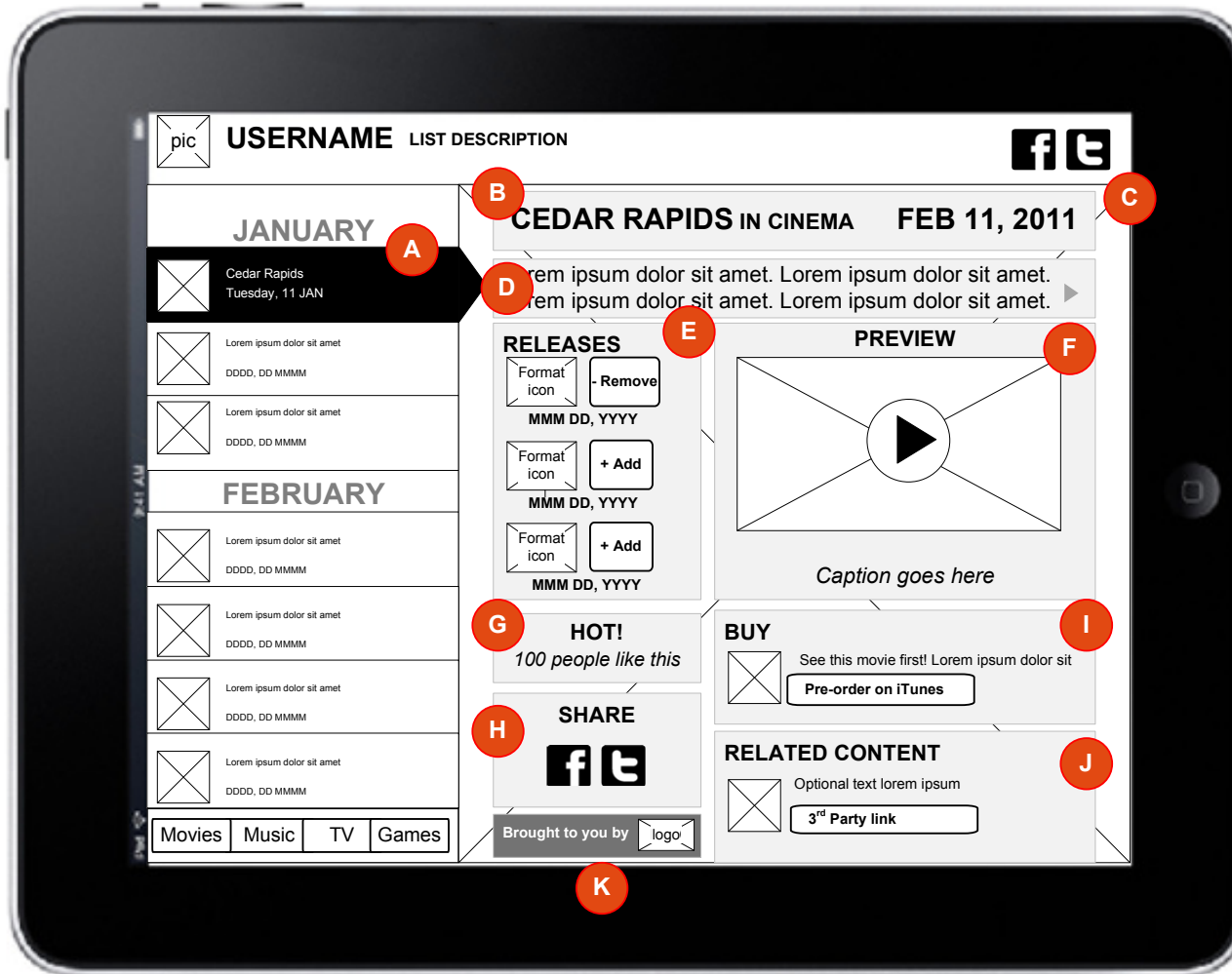

Description

This is the default screen for product detail (movie) within the Feed view.

The user **arrives at this screen** if:

- user has selected a product (movie) from anywhere in the application

From this screen the user may:

- Add product release to their calendar (or remove)
- Select overview for more detail
- View trailers and images
- Follow 3rd party links

A PRODUCT MARKER – selected/highlighted product in feed

This indicates the user is looking at the selected product in the detail pane

B PRODUCT NAME, FORMAT & RELEASE DATE

This shows the product name, format and release date, color-coded for the category

C PRODUCT BACKGROUND (OPTIONAL)

Product image or generic background that sits behind the product detail (for sponsored products)

D SHORT PRODUCT DESCRIPTION – with link to more detail

Short description or the first x characters of the product editorial.

GESTURE: tap or swipe to reveal more product editorial

TRANSITION: TBC

9.1. Product Detail: Movie (Landscape) cont..

OVERVIEW CONT..

E PRODUCT RELEASE FORMATS & DATES –

Format releases with option to add or remove release from your own calendar

This allows a user to follow a product release (add to own list). If the user already has the release in their own list, they have the option to remove.

Release formats for movies are:

- Theater
- DVD
- Blu-ray
- Digital (**note**: this category may need to be split into Amazon, iTunes etc.)

GESTURE: tap to add or remove

TRANSITION: TBC

F GALLERY

Gallery includes video (trailers) and images from the movie.

- All **video** is embedded from a 3rd party URL (YouTube or BrightCove)
- **Images** may be embedded from a 3rd party URL or uploaded by IFC editors

GESTURE: swipe left or right to see videos and images

TRANSITION: TBC

G “LIKE” FUNCTION

Number of users who have “liked” this product page

H SHARE CONTENT – via social networks

Share product release on facebook and Twitter

GESTURE: TBC

TRANSITION: TBC

I BUY LINKS (EXTERNAL)

External links to purchase. There can be 0 or more links for any movie.

Each item includes:

- thumbnail (optional)
- description (optional)
- link
- link caption

GESTURE: tap to open external link

TRANSITION: TBC

J RELATED CONTENT LINKS (EXTERNAL)

External links to related content. There can be 0 or more links for any movie.

Each item includes:

- thumbnail (optional)
- description (optional)
- link
- link caption

GESTURE: tap to open external link

TRANSITION: TBC

K OPTIONAL CONTENT SOURCE

Some products may have a ‘source’ (e.g. IMDB or Electronic Arts etc.) If a product does not have a source, this field does not display within the app.

The source consists of:

- logo (optional)
- external link (optional)

9.1. Product Detail: Movie (Landscape) cont..

EDITORIAL DETAIL

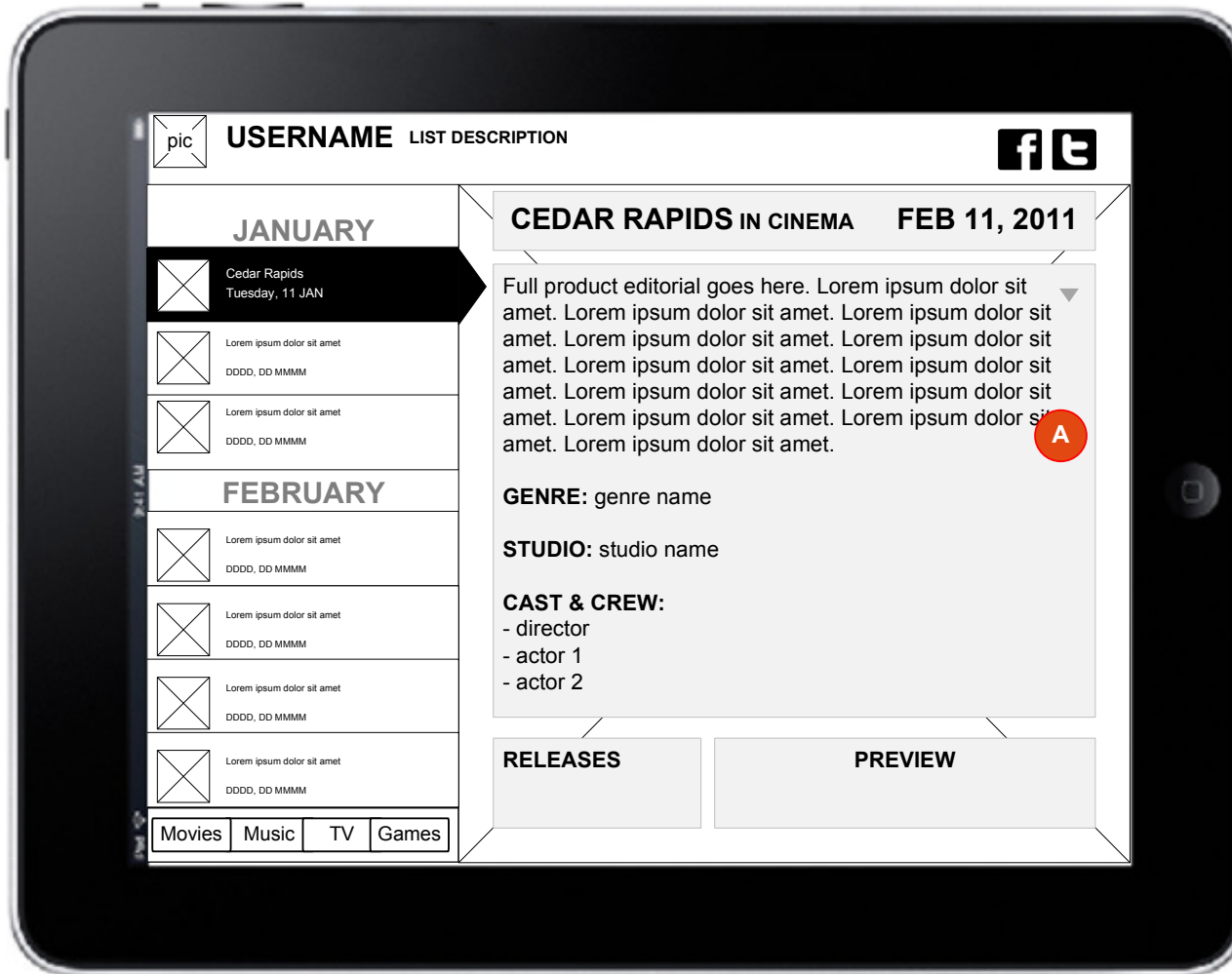

Description

This view shows the expanded product detail & editorial view for a movie.

The user **arrives at this screen** if:

- user has selected to view the product detail for any movie

A FULL PRODUCT DESCRIPTION & EDITORIAL – all movie-specific detail

Includes:

- product description/editorial
- genre
- studio
- cast

GESTURE:

- swipe up/down to scroll through content
- tap to close product detail

TRANSITION: TBC

9.2. Product Detail: TV (Landscape)

OVERVIEW



Description

This is the default screen for product detail (TV) within the Feed view.

The user **arrives at this screen** if:

- user has selected a product (TV) from anywhere in the application

From this screen the user may:

- Add product release to their calendar (or remove)
- Select overview for more detail
- View trailers and images
- Follow 3rd party links

A PRODUCT RELEASE FORMATS & DATES –

Format releases with option to add or remove release from your own calendar

This allows a user to follow a product release (add to own list). If the user already has the release in their own list, they have the option to remove.

Release formats for TV are:

- On air/on TV
- DVD
- Blu-ray
- Digital (*note*: this category may need to be split into Amazon, iTunes, Hulu etc.)

GESTURE: tap to add or remove

TRANSITION: TBC

9.2. Product Detail: TV (Landscape) cont..

EDITORIAL DETAIL

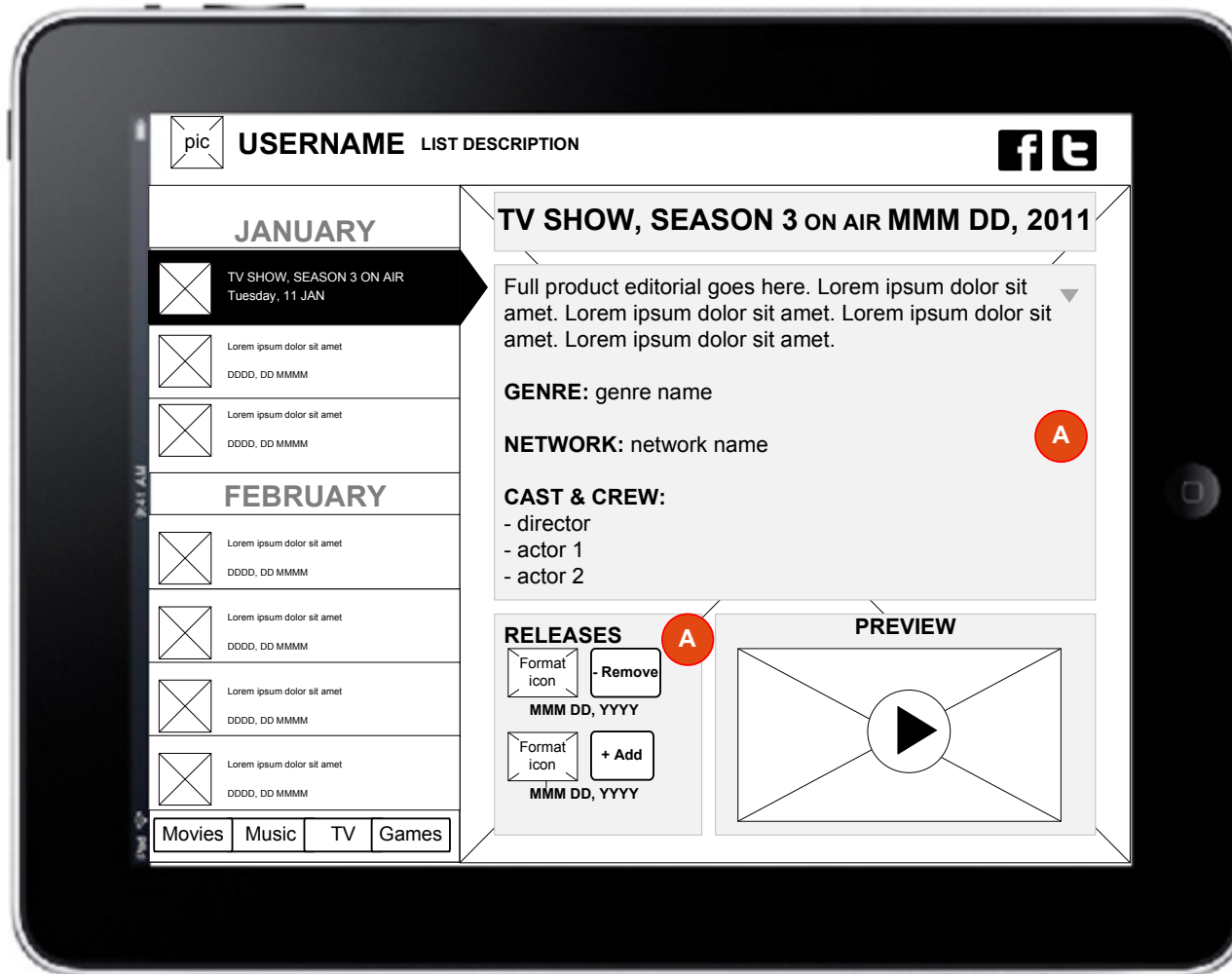

Description

This view shows the expanded product detail & editorial view for a TV series.

The user **arrives at this screen** if:
- user has selected to view the product detail for any tv show

A FULL PRODUCT DESCRIPTION & EDITORIAL – all tv-specific detail

Includes:

- product description/editorial
- genre
- network
- cast & crew

GESTURE:

- swipe up/down to scroll through content
- tap to close product detail

TRANSITION: TBC

9.3. Product Detail: Music (Landscape)

OVERVIEW

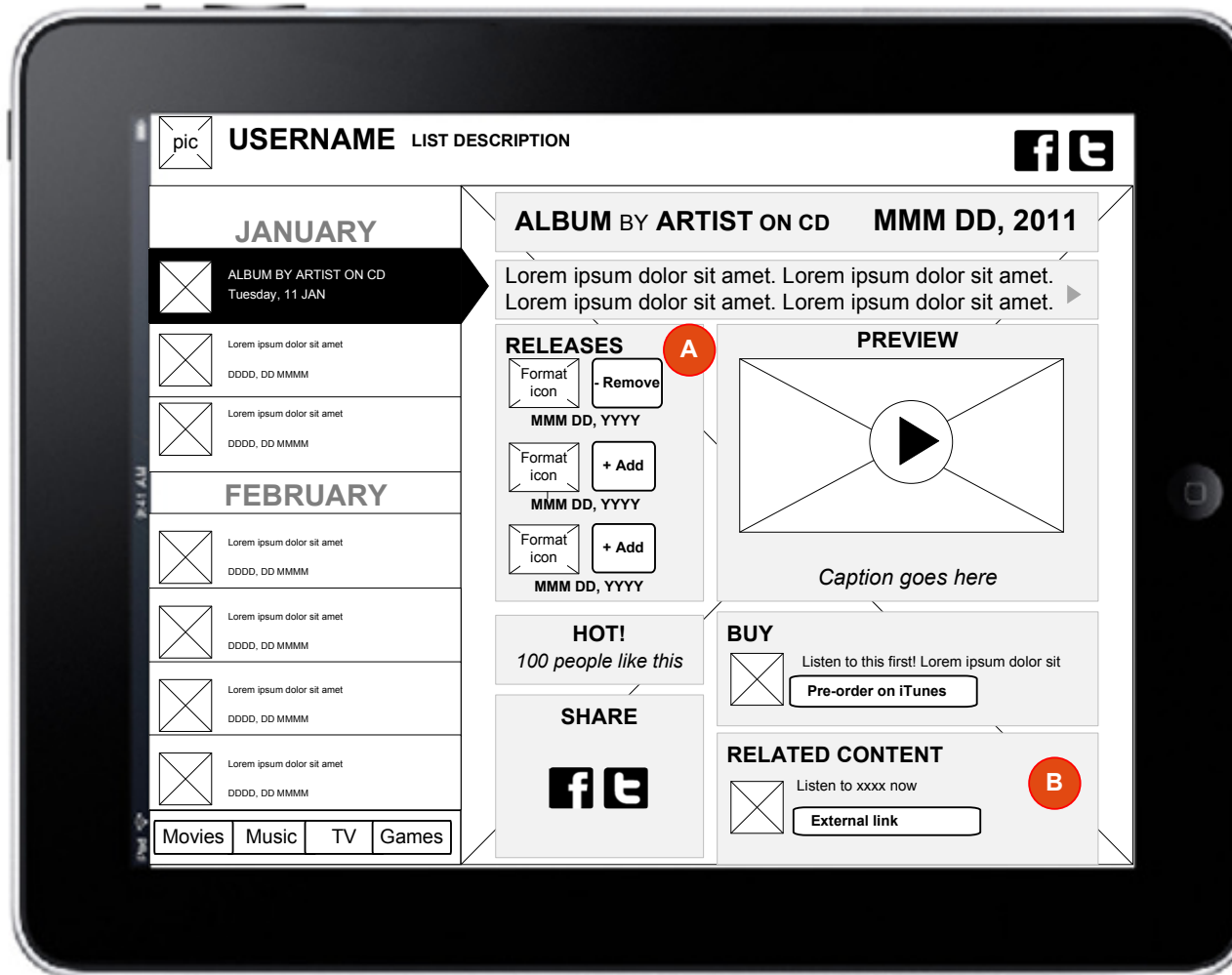

Description

This is the default screen for product detail (Music) within the Feed view.

The user **arrives at this screen** if:

- user has selected a product (music) from anywhere in the application

From this screen the user may:

- Add product release to their calendar (or remove)
- Select overview for more detail
- View trailers and images
- Follow 3rd party links

A PRODUCT RELEASE FORMATS & DATES – Format releases with option to add or remove release from your own calendar

This allows a user to follow a product release (add to own list). If the user already has the release in their own list, they have the option to remove.

Release formats for Music are:

- CD
- Digital (**note**: this category may need to be split into Amazon, iTunes, Hulu etc.)

GESTURE: tap to add or remove

TRANSITION: TBC

B RELATED CONTENT LINKS (EXTERNAL)

Note that the external content links may also include links to audio files in Apple's supported formats: HE-AAC (V1), AAC (16 to 320 Kbps), Protected AAC (from iTunes Store), MP3 (16 to 320 Kbps), MP3 VBR, Audible (formats 2, 3, and 4), Apple Lossless, AIFF, and WAV

9.3. Product Detail: Music (Landscape) cont..

EDITORIAL DETAIL

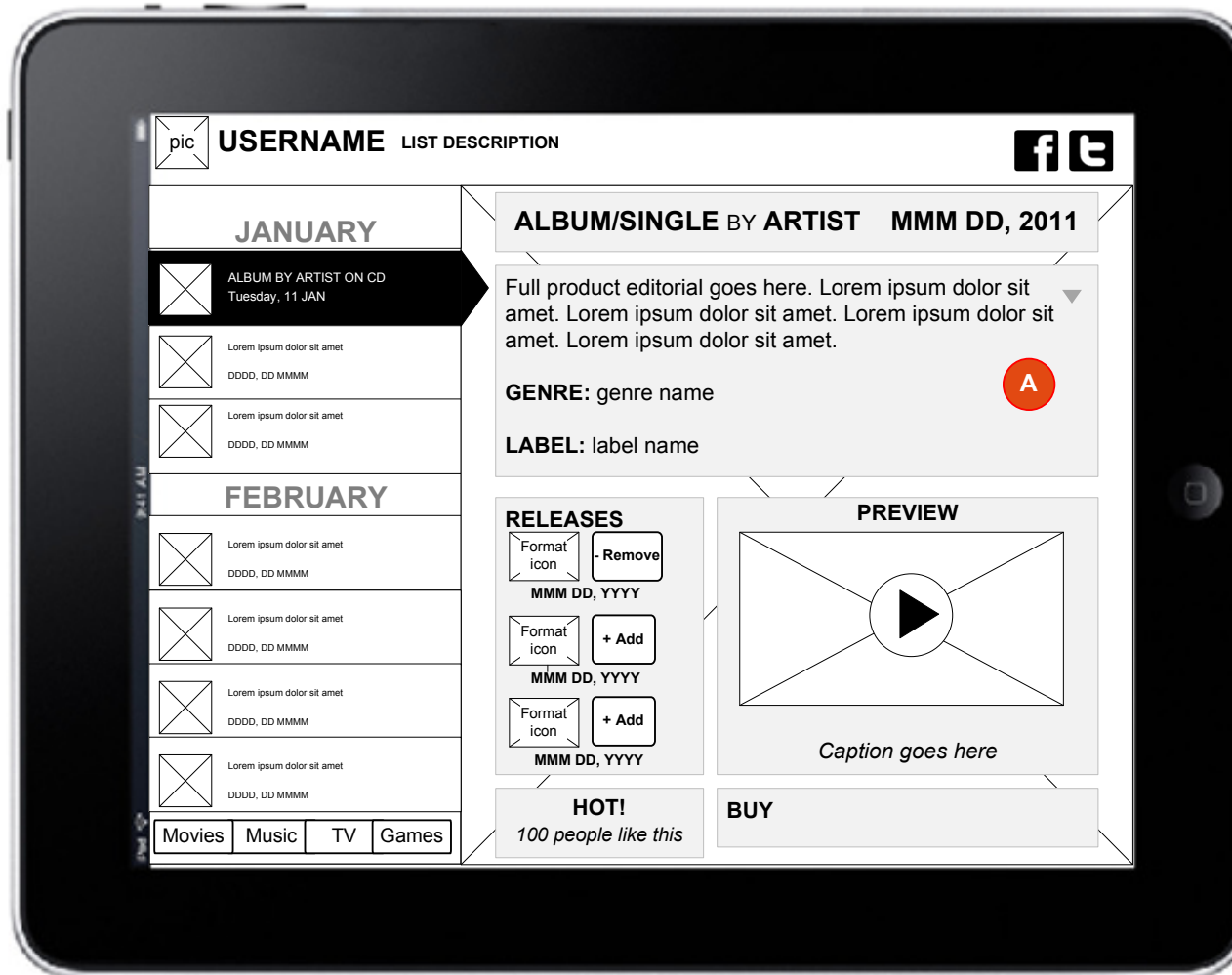

Description

This view shows the expanded product detail & editorial view for a music release (album or single).

The user **arrives at this screen** if:

- user has selected to view the product detail for any music release

A FULL PRODUCT DESCRIPTION & EDITORIAL – all music-specific detail

Includes:

- product description/editorial
- genre
- label

GESTURE:

- swipe up/down to scroll through content
- tap to close product detail

TRANSITION: TBC

9.4. Product Detail: Games (Landscape)

OVERVIEW

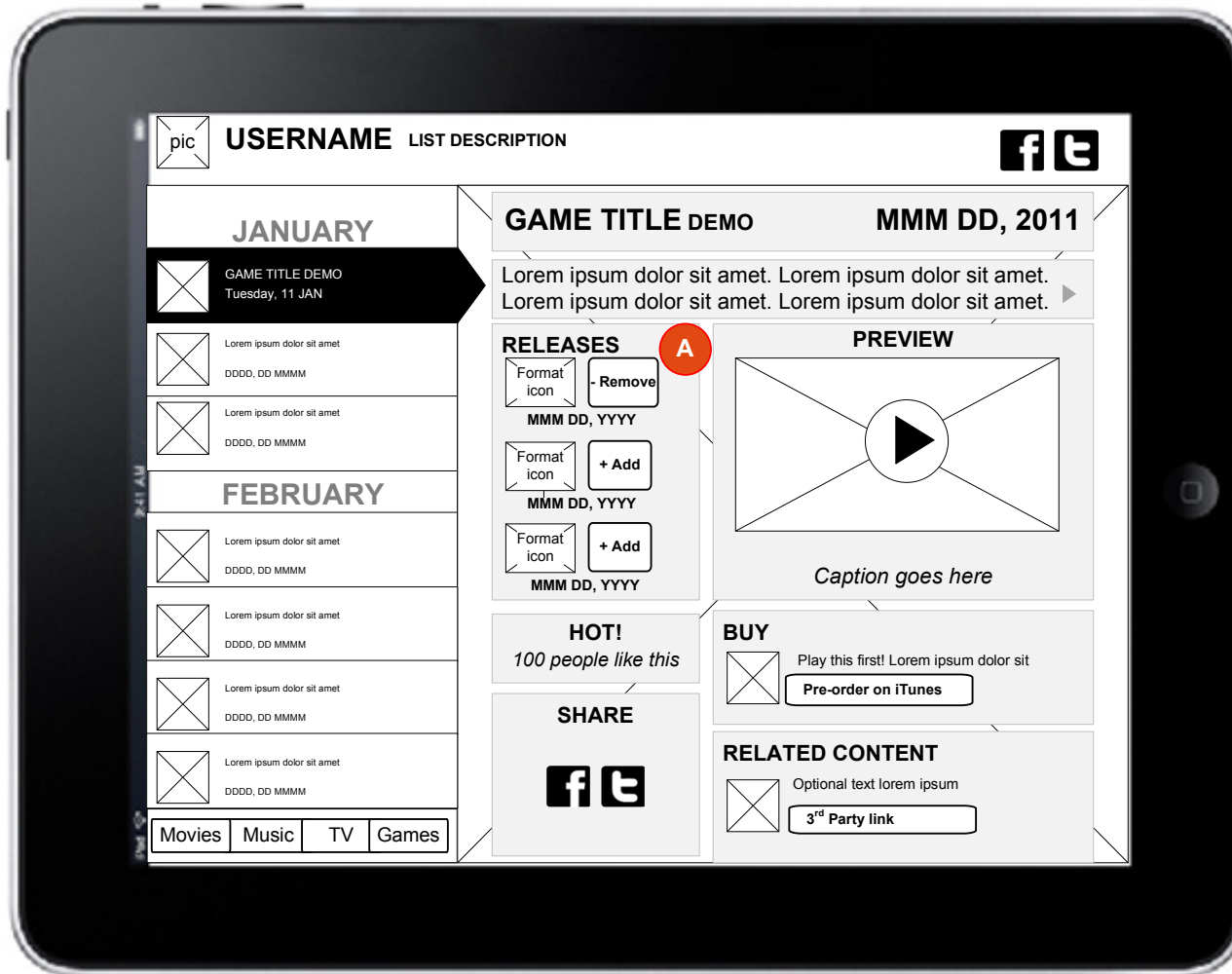

Description

This is the default screen for product detail (games) within the Feed view.

The user **arrives at this screen** if:

- user has selected a product (games) from anywhere in the application

From this screen the user may:

- Add product release to their calendar (or remove)
- Select overview for more detail
- View trailers and images
- Follow 3rd party links

A PRODUCT RELEASE FORMATS & DATES –

Format releases with option to add or remove release from your own calendar

This allows a user to follow a product release (add to own list). If the user already has the release in their own list, they have the option to remove.

Release formats for games are:

- Demo
- XBOX 360/Kinect
- PlayStation/Move
- Wii
- DS/Dsi/3DS
- iPhone/iPad
- Android
- Digital (**note**: this category may need to be split)

GESTURE: tap to add or remove

TRANSITION: TBC

9.4. Product Detail: Games (Landscape) cont..

EDITORIAL DETAIL

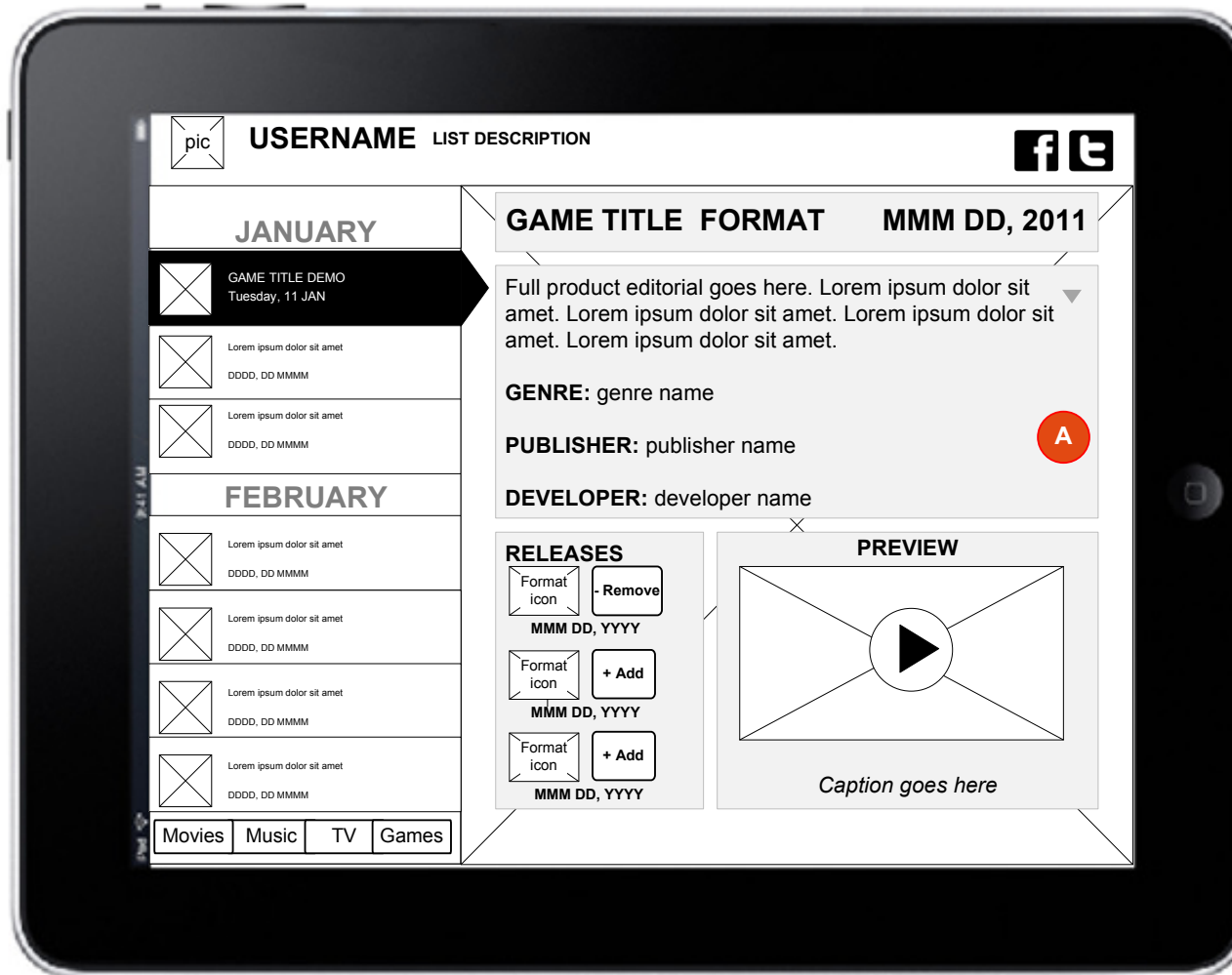

Description

This view shows the expanded product detail & editorial view for a game release.

The user **arrives at this screen** if:

- user has selected to view the product detail for any game release

A FULL PRODUCT DESCRIPTION & EDITORIAL – all game-specific detail

Includes:

- product description/editorial
- genre
- publisher
- developer

GESTURE:

- swipe up/down to scroll through content
- tap to close product detail

TRANSITION: TBC

9.5. Product Detail: Related Links (Landscape)

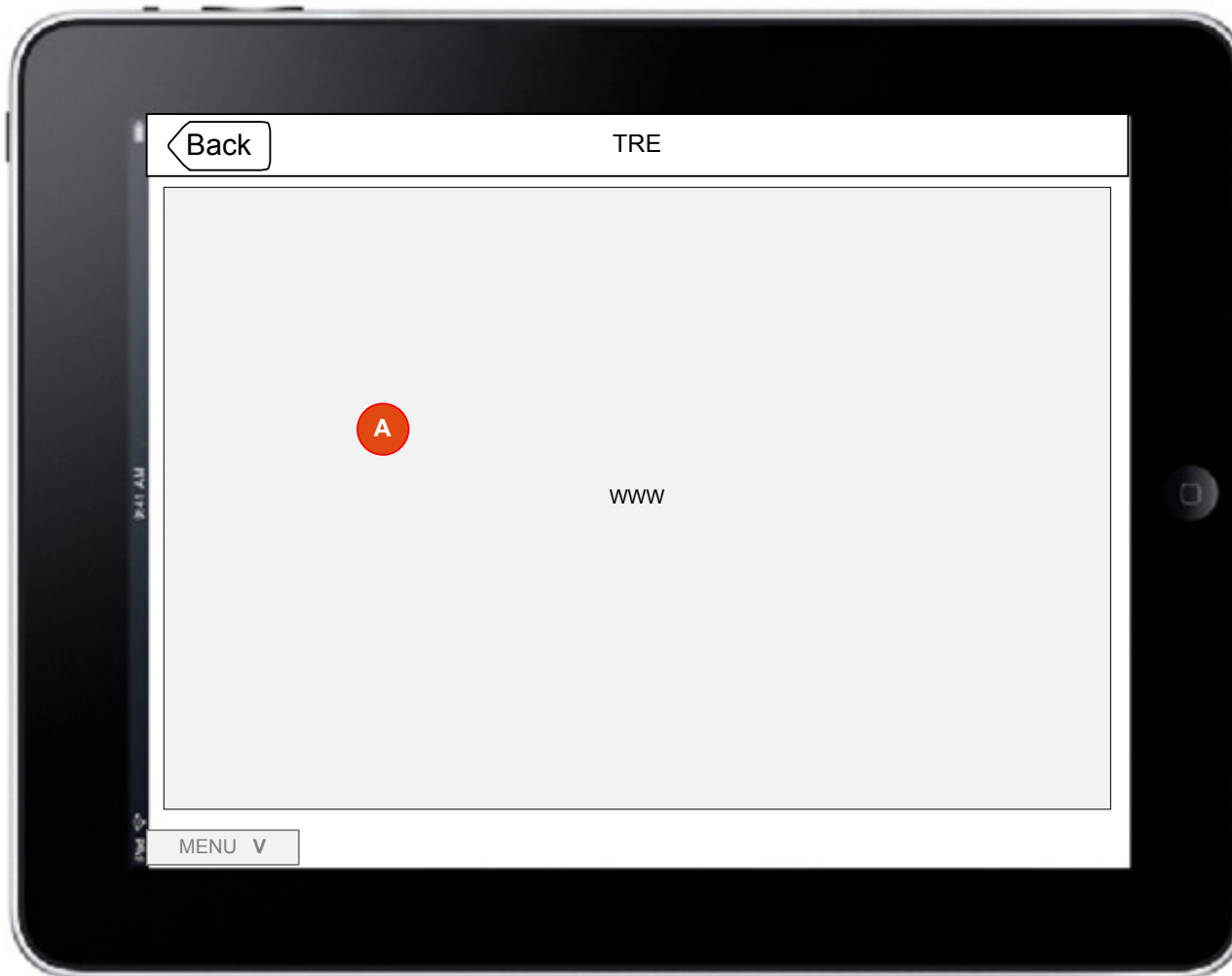

Description

This screen shows external product links.

The user **arrives at this screen** if:

- user has selected an external 'buy' or 'content' link from any product page

From this screen the user may:

- Browse the external page/site
- Use the app's nav to return to any app content

A EXTERNAL CONTENT

External content displayed within app shell.

10.0 Help/Tips (Landscape)

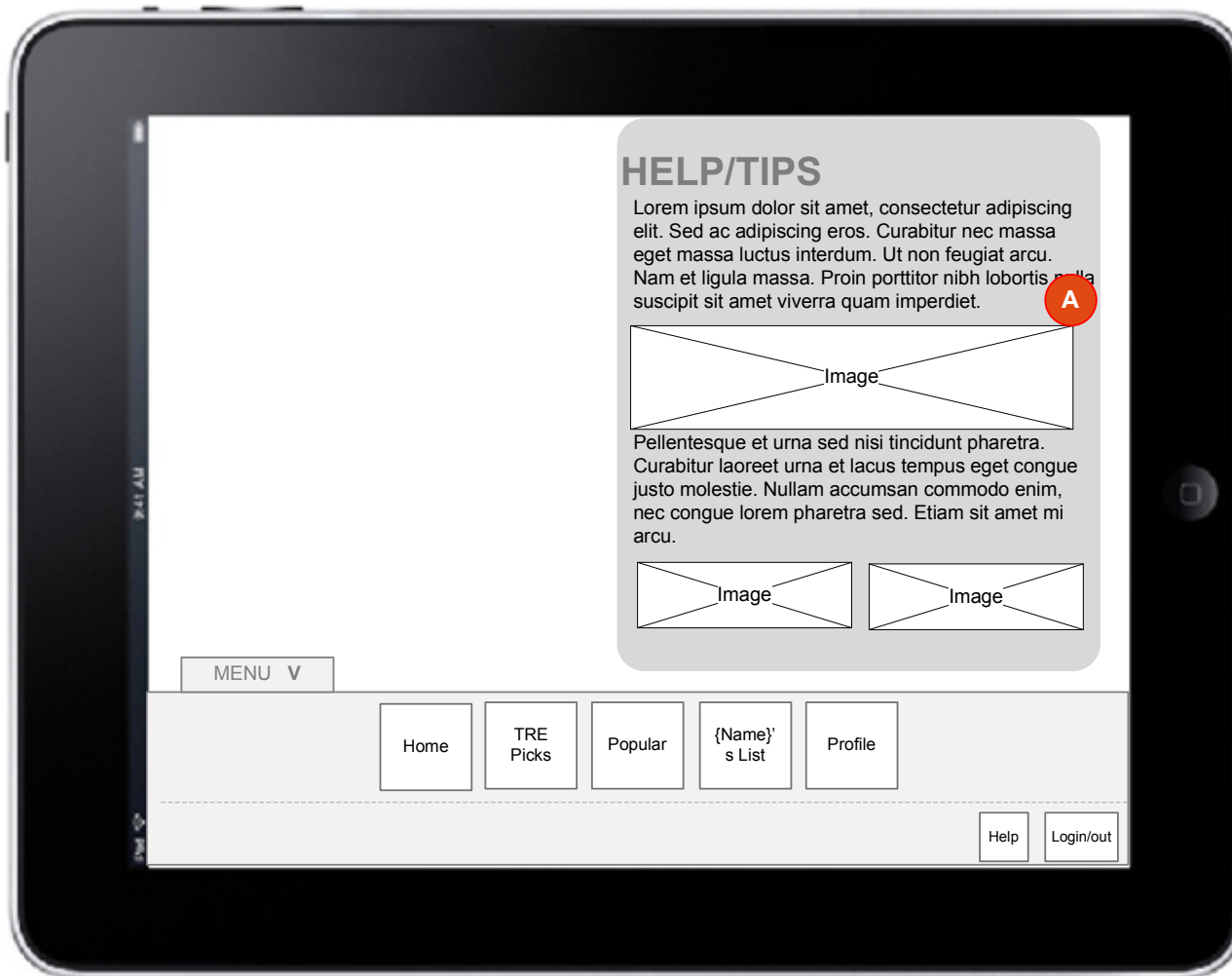

Description

The help/tips modal explains how users should navigate through the app with swiping and multi-touch interactions.

The user arrives here if they have selected 'Help' from the main nav.

A TIPS MODAL

This includes text and/or images decides to demonstrate interactions.

GESTURE:

- swipe up/down to scroll through content

TRANSITION: TBC

11.0 Login (Landscape)

LOGIN VIA FACEBOOK CONNECT



Description

The login dialog/s display whenever the user is not logged in and they take an action that requires identification (e.g. add to list, share)

11.0 Login (Landscape) cont..

EXTENDED PERMISSIONS VIA FACEBOOK CONNECT

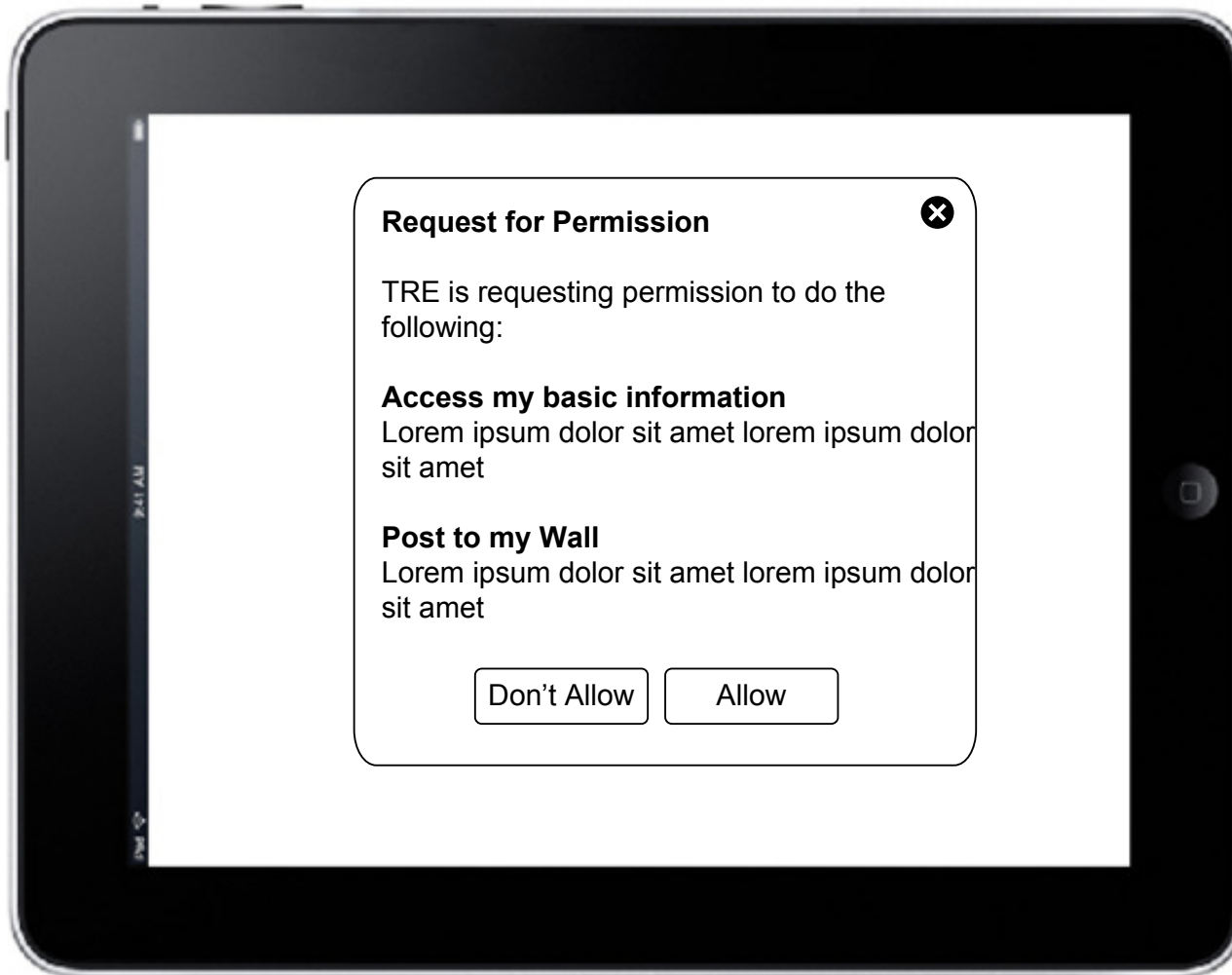

Description

The login dialog/s display whenever the user is not logged in and they take an action that requires identification (e.g. add to list, share)

12.1 Share via Facebook

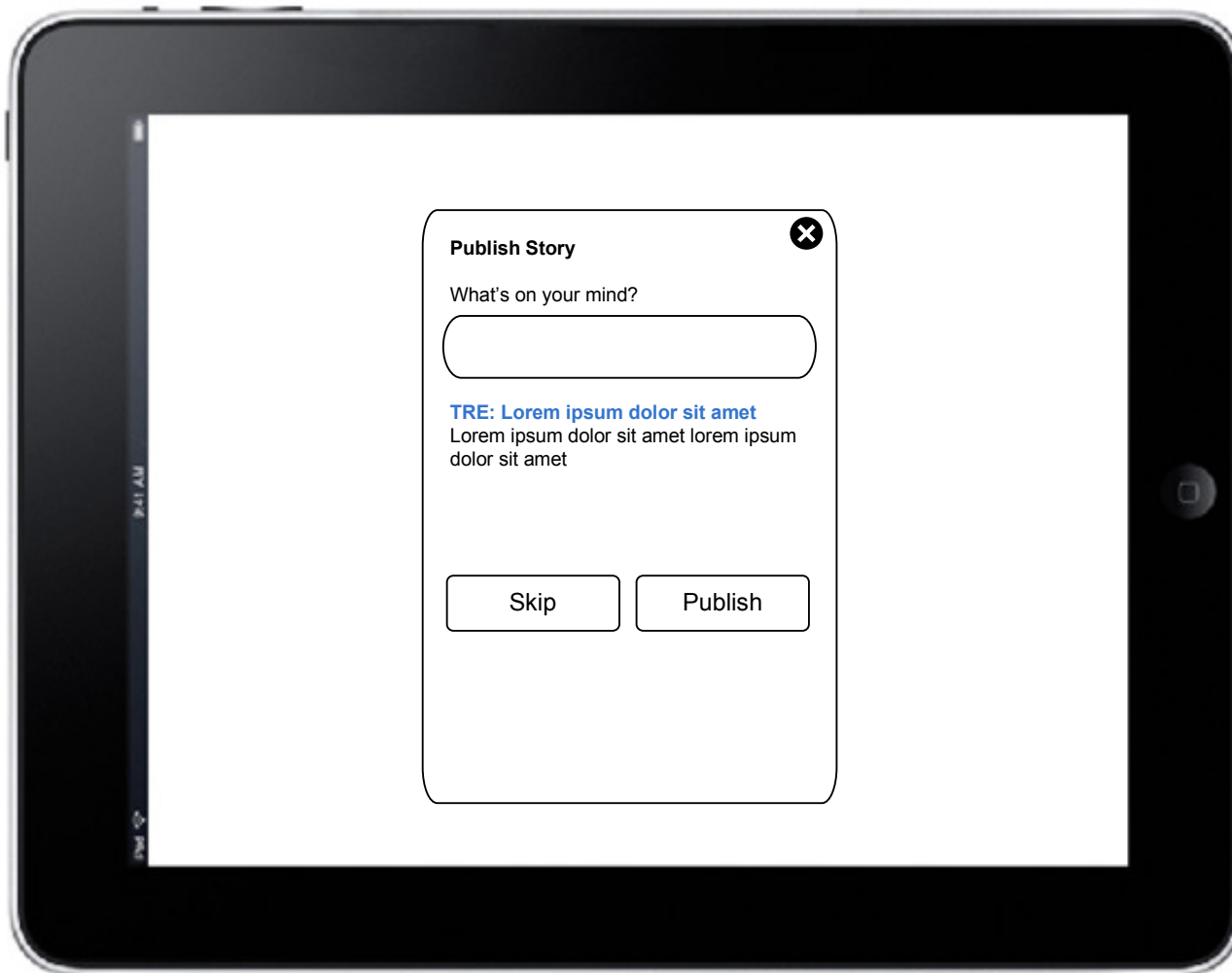

Description

The Facebook publish dialog displays whenever the user chooses to share.

If the user has chosen to share a **list**:

- Description = TBC
- Link = TBC

If the user has chosen to share a **product**:

- Description = TBC
- Link = TBC

12.2 Share via Twitter

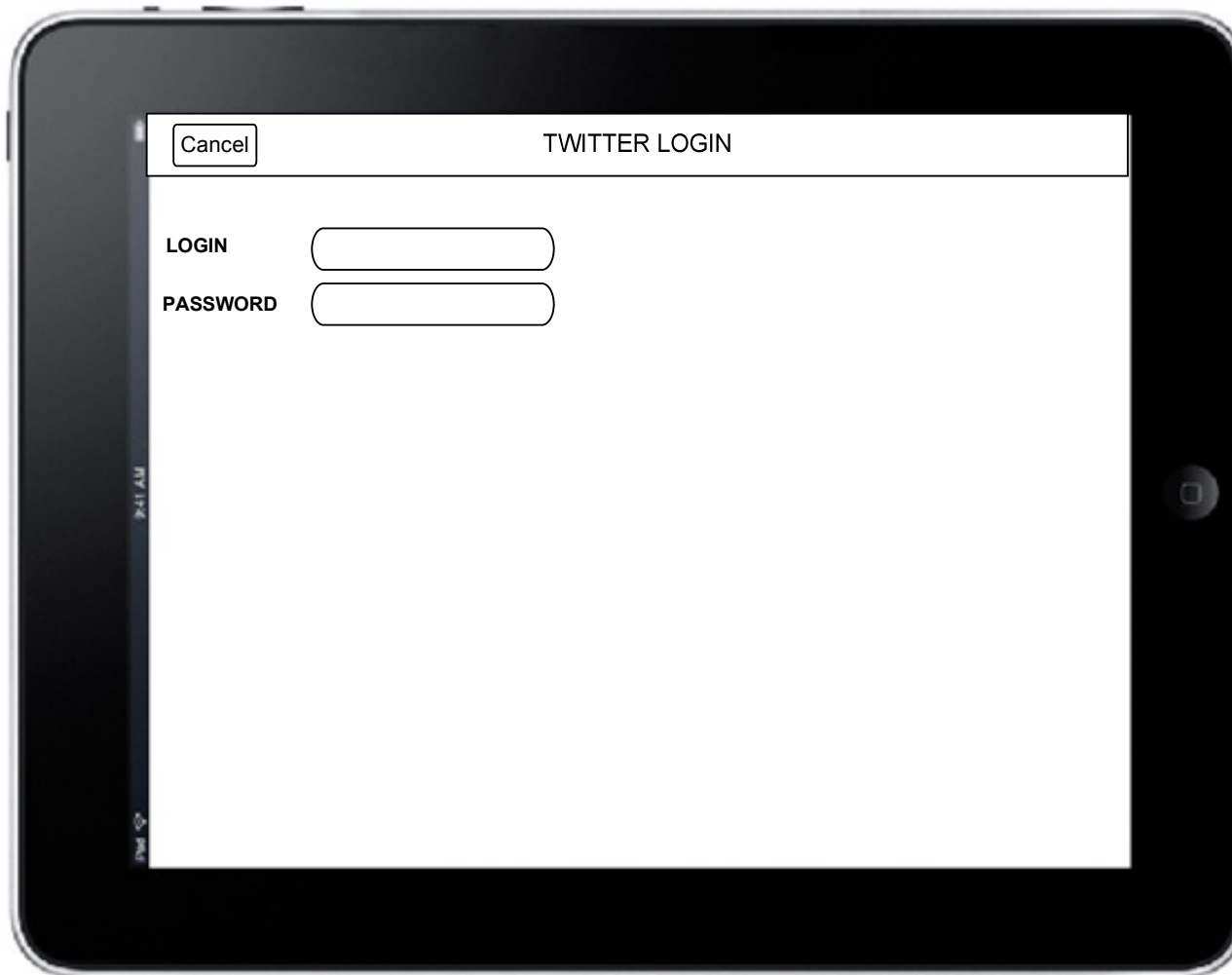

Description

The Twitter login dialog displays whenever the user chooses to share.

If the user has chosen to share a **list**:

- Tweet = TBC

If the user has chosen to share a **product**:

- Tweet = TBC

13.0 Supplementary Screens

LOST CONNECTION DIALOG

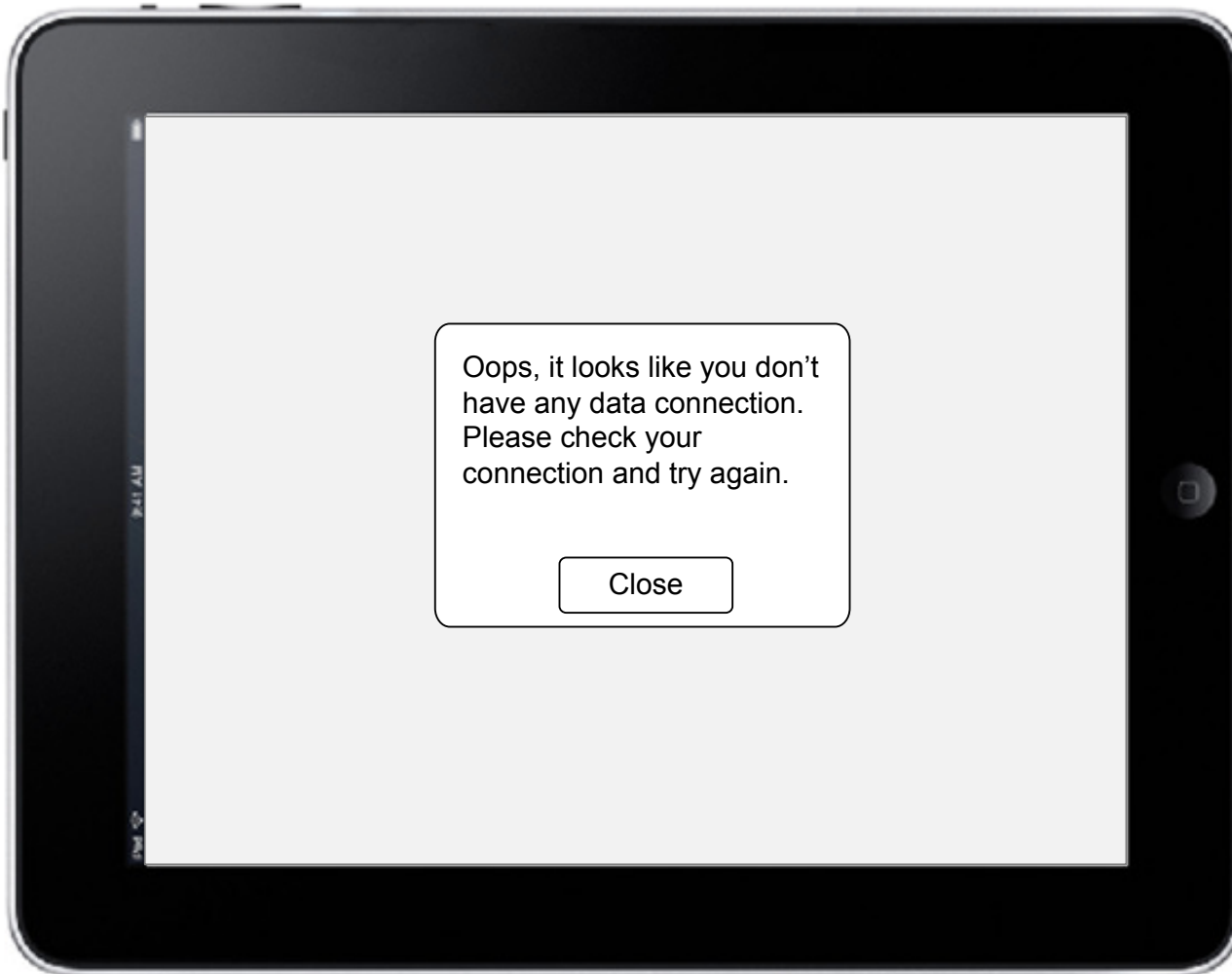

Description

The lost connection dialog box displays whenever the user loses connection.

13.0 Supplementary Screens

ERROR DIALOG

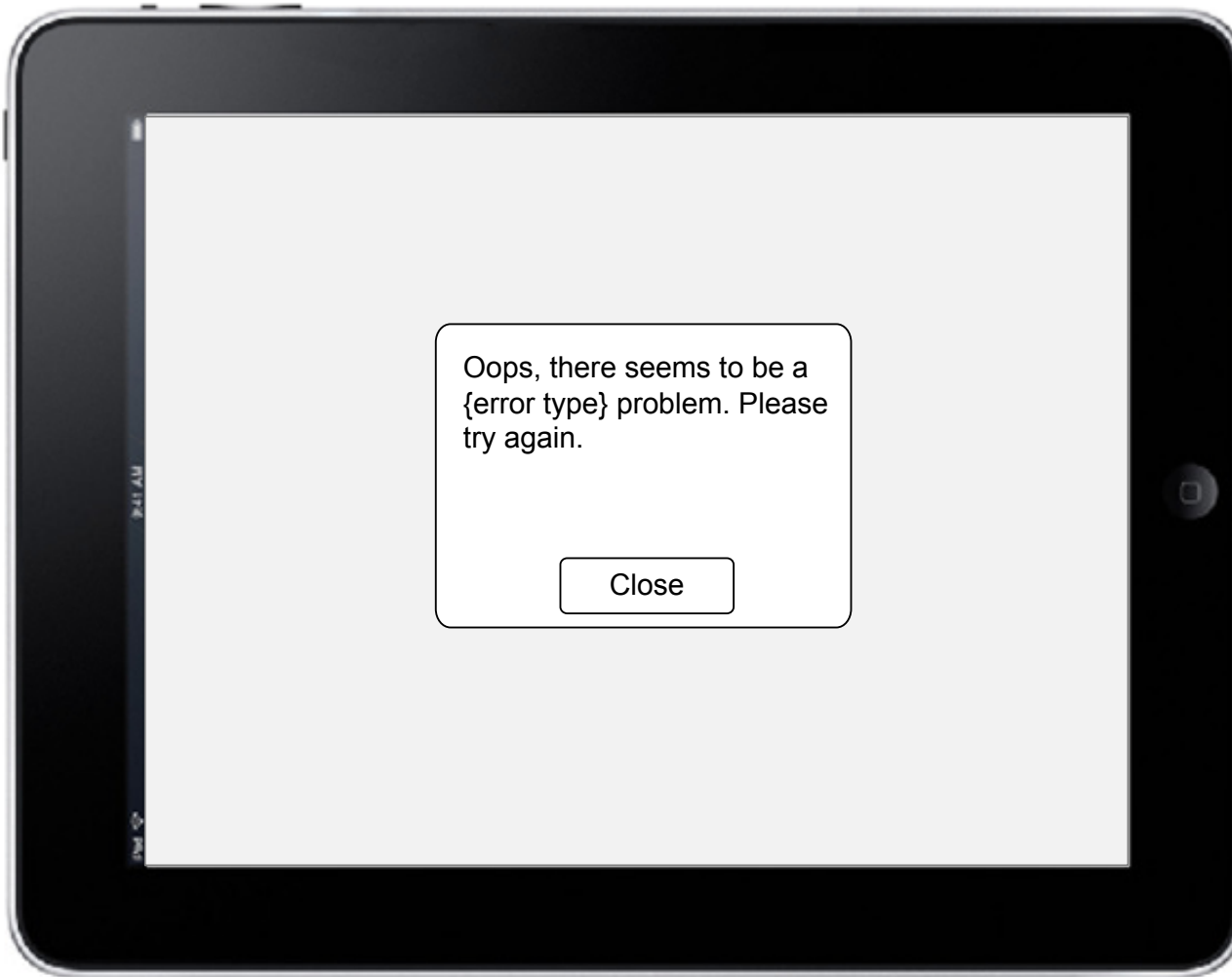

Description

The error dialog box displays whenever there is a problem retrieving or saving information.